

ELECTRONIC CONTROL UNIT

PARTS DIAGRAM

Item	Description	Part No.
1	ECU Box (Standard/Industrial)	ECUB / ECUIB
2	Control Board (Single/Master-Slave)	DUPCB10 / DUMSCB10
3	Toroid Transformer, 10 awg	DUTO10
4	EMI Board	DUEMI10
5	Battery (2)	DUBA10
6	Battery Fuse Holder	VABFH
7	Motor Harness	ECUMTHRN
8	Power Harness	DUPHC
9	Alarm	DUAL10
10	ECU Access Key	ECUKEY
11	ECU Key Cylinder	ECUKEYC
12	Reset Switch	ECURW
13	Fuse Kit	DUFSK10
14	Radio Antenna Kit	VARAK
15	Strain Relief	DH3/4NMCC
16	Mounting Plate (Single/Master-Slave)	ECUMPS10 / ECUMPMS10
17	7-Conductor Cable, 16 ga.	VA-CB16
18	Warning Placard	DUWPA

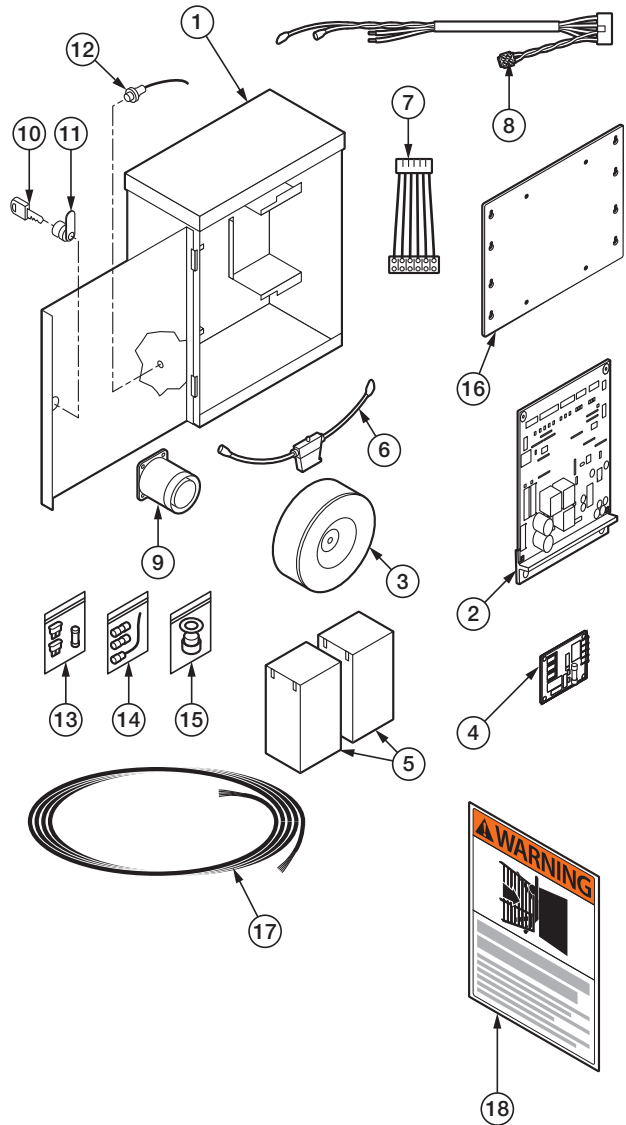

WARNING - For Installation By Qualified Personnel Only.

Corporate Headquarters
631 Wald, Irvine, CA 92618

TECHNICAL SUPPORT 1 800 908 0884



CONTROL BOX INSTALLATION

WARNING - If the control box is not mounted properly it may fall, causing damage and/or injury. The Electronic Control Unit (ECU) weight is approximately 40 lbs. Be sure that the substrate being mounted to and the fasteners being used are appropriate to support the weight of the control box.

1. Disconnect the Siren and Stop Button Leads from the Control Board. Remove the Control Board Mounting Plate. The plate is held in the box by four screws.

2. Position the ECU Box in the desired place and mark the mounting holes. Prepare the holes to receive the anchors/fasteners.

3. Position the ECU Box and secure it to the mounting surface using the Sealed Washers provided (place the rubber side of the washers against the inside of the control box).

Note: Depending on type of anchor used, it may be necessary to enlarge the mounting holes in the control box.

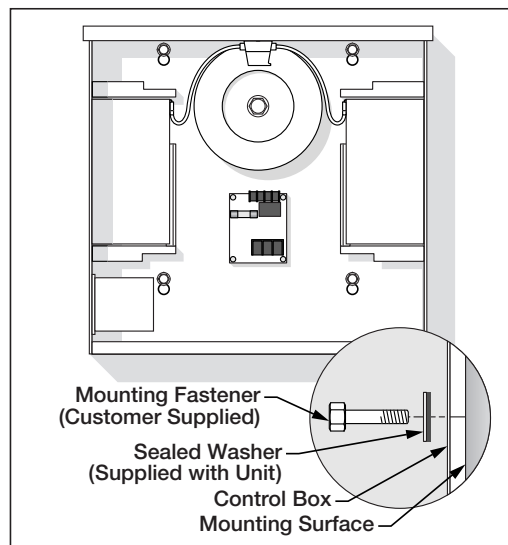
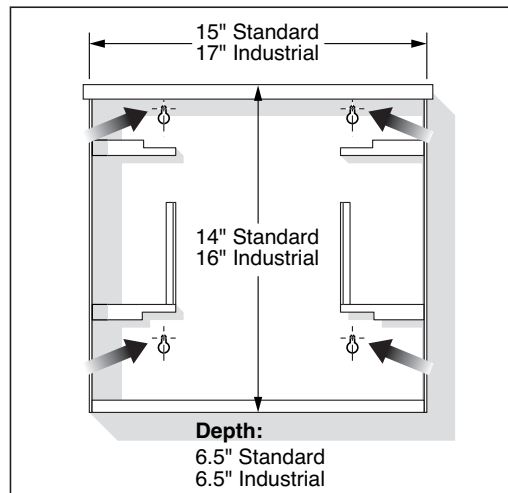
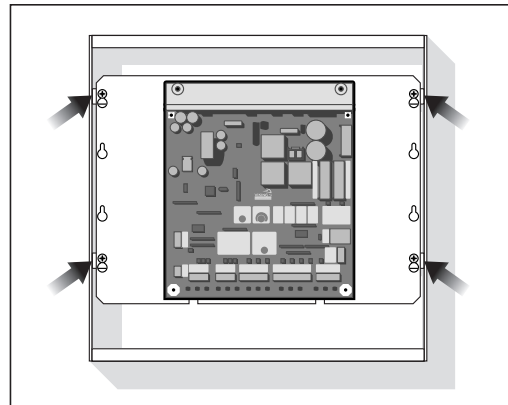

Corporate Headquarters
631 Wald, Irvine, CA 92618

ACCESS SYSTEMS™ TECHNICAL SUPPORT 1 800 908 0884