

# VIKING POWER BOX

## For Viking Vehicular Gate Operators

1. Position the Power Box in the desired place and mark the mounting holes. Prepare the holes to receive the anchors/fasteners.

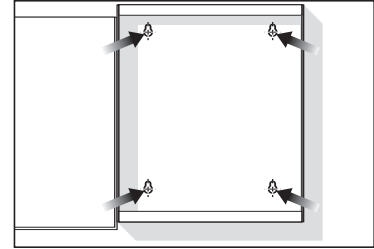

2. Position the Power Box and secure it to the mounting surface using the Sealed Washers provided (place the rubber side of the washers against the inside of the power box).

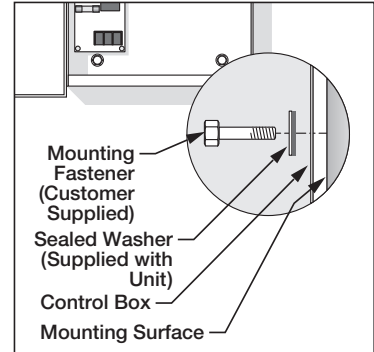

**Note:** Depending on type of anchor used, it may be necessary to enlarge the mounting holes in the control box.

1. Turn off the main switch or breaker for the power line being used.
2. Move the selector switch on the Incoming Voltage Selector to the proper position (115 for 110 to 120VAC, 230 for 200 to 240VAC).
3. Connect the incoming power wires to the terminals as shown in the illustration.

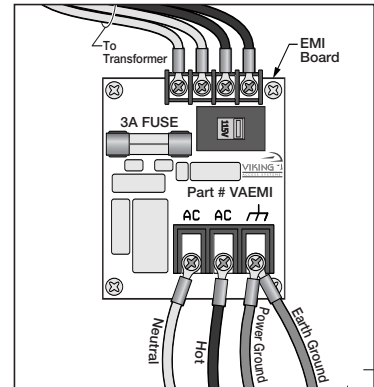

4. Connect the **LOW VOLTAGE** wire to the Terminal Block. Polarity **DOES NOT** matter.
5. Use the Strain Relief provided to secure the wiring.

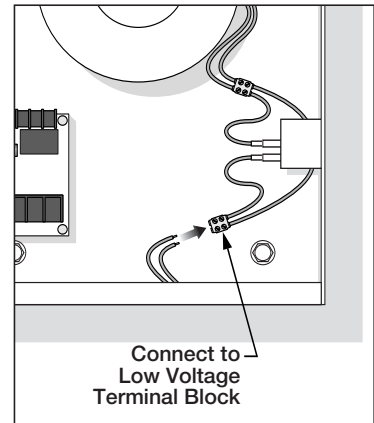

## Wire Gauge Table

10AWG	G-5 Single	X-9 Single	G-5 Master/Slave	X-9 Master/Slave	F-1	L-3
Max. Dist.	1000 ft.	1000 ft.	500 ft.	500 ft.	500 ft.	400 ft.

**Note:** Wire size information provided only as a guideline.

**Note:** Consult local Building Codes and City Codes in the installation area before installing this device. Code compliance is the responsibility of the installer.



Corporate Headquarters  
631 Wald, Irvine, CA 92618

TECHNICAL SUPPORT 1 800 908 0884